

# CB 70 P

Part No.	Length	Adaptor
PA 1290	20'	1/8 G
PA 1291	20'	Central

# CB 50 - CB 70

Plasma - Gun

# CB 50 P

Part No.	Length	Adaptor
PA 1280	20'	1/8 G
PA 1281	20'	Central

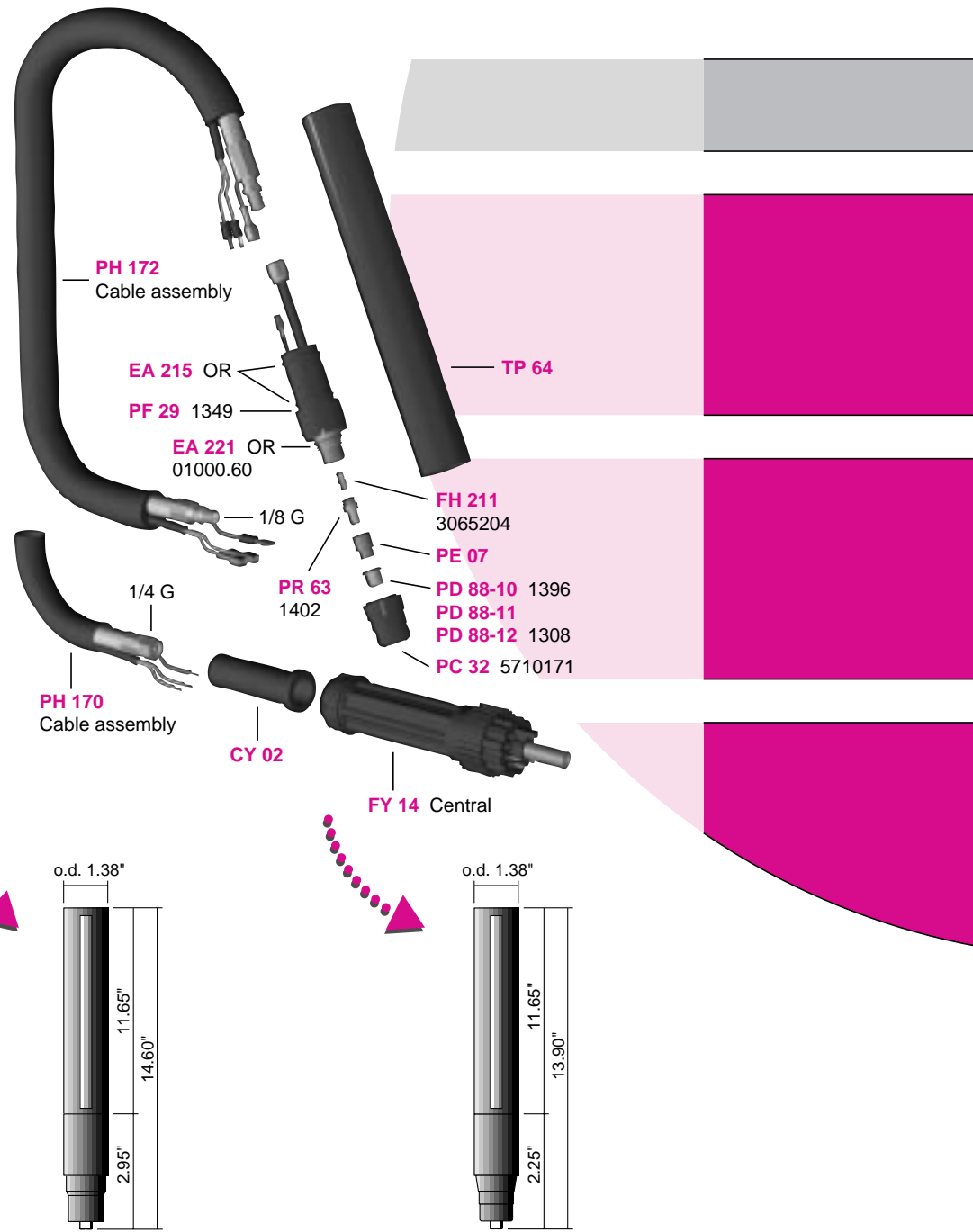
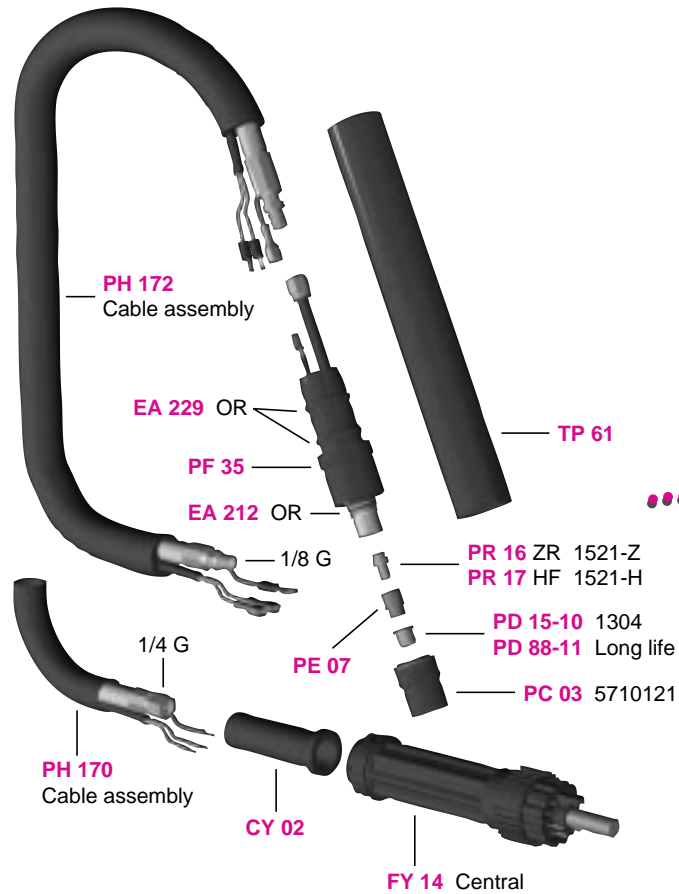

## Specifications

	CB 50	CB 70
Gas	Air	Air
Gas Pressure (psi)	72.5	72.5
Gas Flow (scfh)	350	361
Duty Cycle 100%	40 A	50 A
Duty Cycle 60%	50 A	70 A



**trafimet<sup>®</sup> USA**  
your welding partner

700 East Elm Avenue, Uni B  
La Grange, IL - 60525  
Ph. 708 - 5795893 • Fax 708 - 5795884  
E-mail: TrafimetUS@aol.com

We reserve the right to modify, without notice, any of our products. Trafimet is no way affiliated with Cebora<sup>®</sup>. The parts advertised for sale are not genuine Cebora<sup>®</sup> parts, but are parts made for and by TRAFIMET<sup>®</sup>. References to manufacturer equipment, and/or trade names or trade-marks are for identification and convenience only. TRAFIMET<sup>®</sup> spa is the registered owner of all trademarks patents and models.

Copyright © November 1997 • by TRAFIMET spa

**trafimet<sup>®</sup> USA**  
your welding partner

